

DIP P.C.Board Layout
(TOLERANCE = ±0.05)

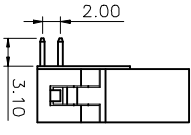

R/A TYPE

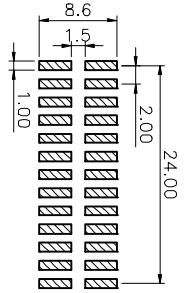
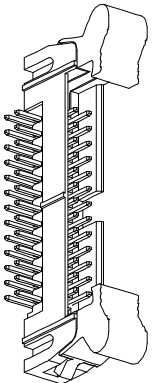

SMT P.C.Board Layout
(TOLERANCE = ±0.05)

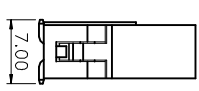

SMT TYPE

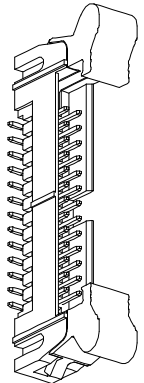

REV.	DESCRIPTION	DRAWN	CHECKED	APPROVED
A	NEW RELEASE	ZQJ 11/18/2014		
B	ADD P/N CODE	CJJ 11/18/2014		

NOTES:

1.MATERIALS

- Contact: copper alloy
- Insulation: Thermoplastic(UL94 V-0)

2.SPECIFICATION

- Storage Temperature:-40°C~+105°C
- Contact Resistance:20mΩ max.(initial)
- Insulation Resistance:1,000MΩ min
- Dielectric Withstanding Voltage:AC 500V Per Minute

3.PRODUCT NUMBER CODE:

LL1030-3 - X X X X X X

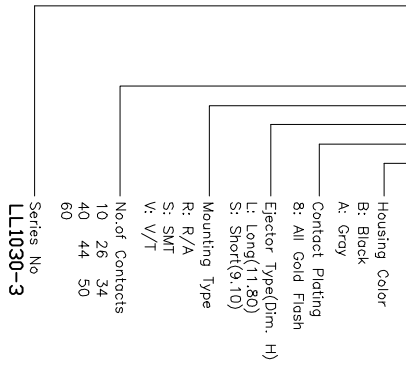

GENERAL TOLERANCE	ANGLE TOLERANCE	PROJECTION	TITLE
X: ±0.60	X: ±5°	UNITS	SHROUDED HEADER PITCH 2.0mm
.X: ±0.38	.X: ±3°	SHEET SIZE	
.XX: ±0.25	.XX: ±2°	A4	LL1030-3
DRAWING TYPE	CUSTOMER	SHEET	
SCALE	1:1	1 OF 1	
DRAWING NO.			

慈溪蓝翎电子有限公司
CIXI LANLING ELECTRONICS CO., LTD.

