

REV.	DESCRIPTION	DRAWN	CHECKED	APPROVED
A	NEW RELEASE	ZQJ 11/18/2014		ZQJ 11/18/2014
B	ADD P/N CODE	CJJ 11/18/2014		

NOTES:

- 1.1 CONTACT RESISTANCE: 20mΩ Max.
- 1.2 DIELECTRIC WITHSTANDING VOLTAGE: 500V AC FOR 1 MINUTE.
- 1.3 INSULATION RESISTANCE: 1000MΩ Min.
- 1.4 OPERATING TEMPERATURE: -40°C~+105°C.
- 1.5 MALE PIN RANGE:  $\phi 0.381 \sim 0.635$ .
- 1.6 CURRENT RATING: 3A Per Pin Max.

2. PRODUCT NUMBER CODE:

LL1019-6 - X X X X X - X

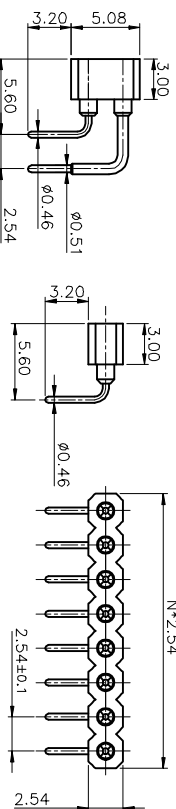

R/A TYPE

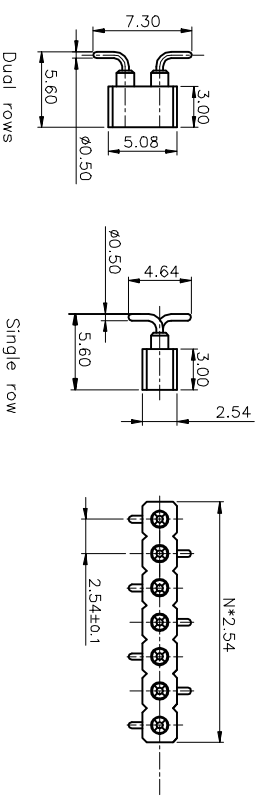

SMT TYPE

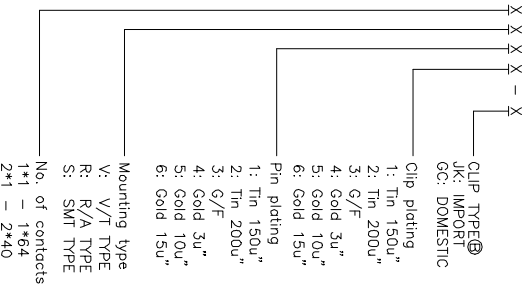

GENERAL TOLERANCE	ANGLE TOLERANCE	PROJECTION	TITLE
X: $\pm 0.60$	X: $\pm 5'$	UNITS	254mm IC SOCKET(Machine Pin)
.X: $\pm 0.38$	.X: $\pm 3'$	SHEET SIZE	RAASMT Type
.XX: $\pm 0.25$	.XX: $\pm 2'$	A4	LL1019-6
DRAWING TYPE: CUSTOMER	SHEET: 10F1	SERIES	
SCALE: 1:1	DRAWING NO.		

**慈溪蓝翎电子有限公司**  
**CIXI LANLING ELECTRONICS CO., LTD.**